

— The —
MANCHESTER



· LEXINGTON ·



Tech Packet

899 Manchester St. | Lexington, KY 40508

General Manager and Booking

Caleb West
859-707-1036
caleb@manchestermusichall.com

Operations

Jess Morris
859-361-4520
jess@manchestermusichall.com

Production

Jeremy Cox
606-309-0340
jeremy@manchestermusichall.com

Marketing and Ticketing

Callia Englund
206-715-8714
callia@manchestermusichall.com



350
Table Seating

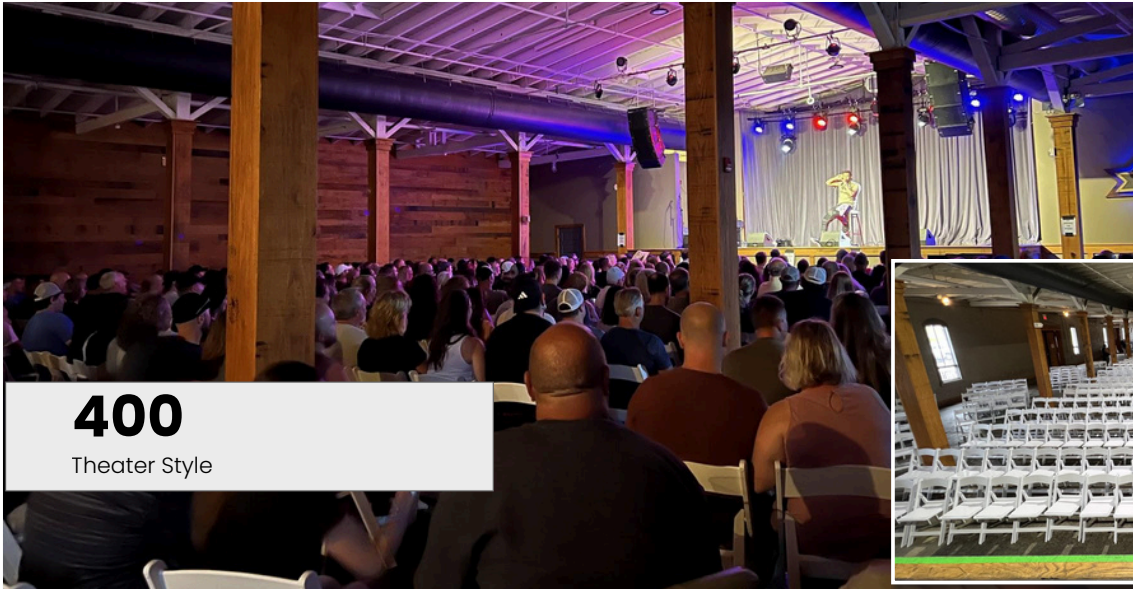

400
Theater Style

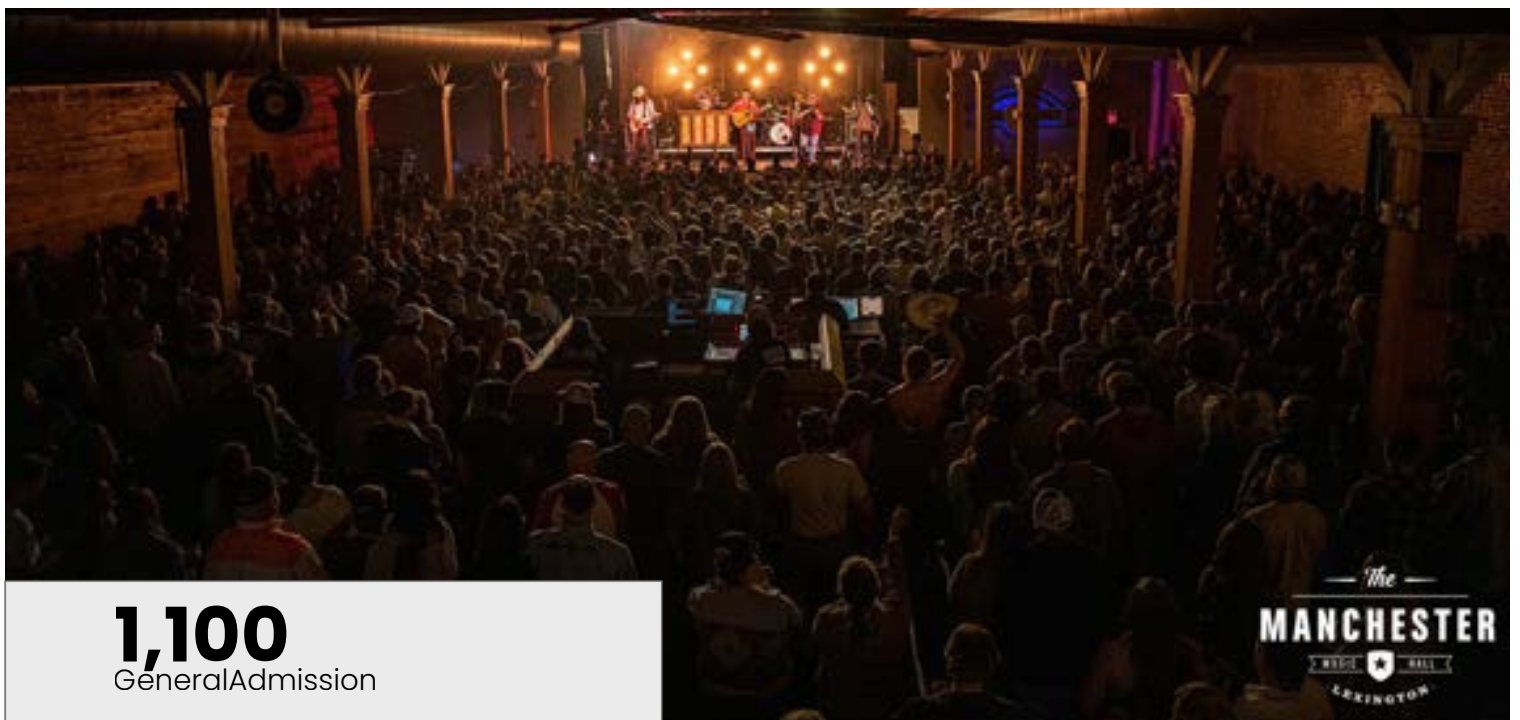

1,100
General Admission

The
MANCHESTER
MUSIC HALL
LEXINGTON

Green Room Suite's

2 Green Rooms 2 Full Bath's Bath
Towels & Stage Towels available



VIP Rooms

10 Person Capacity
Semi-Private Bathroom
Personal Bartender





Stage Dimensions

Typical Headliner Stage

Stage Dimensions

⚡: Dedicated 20A Circuit with Quad Box

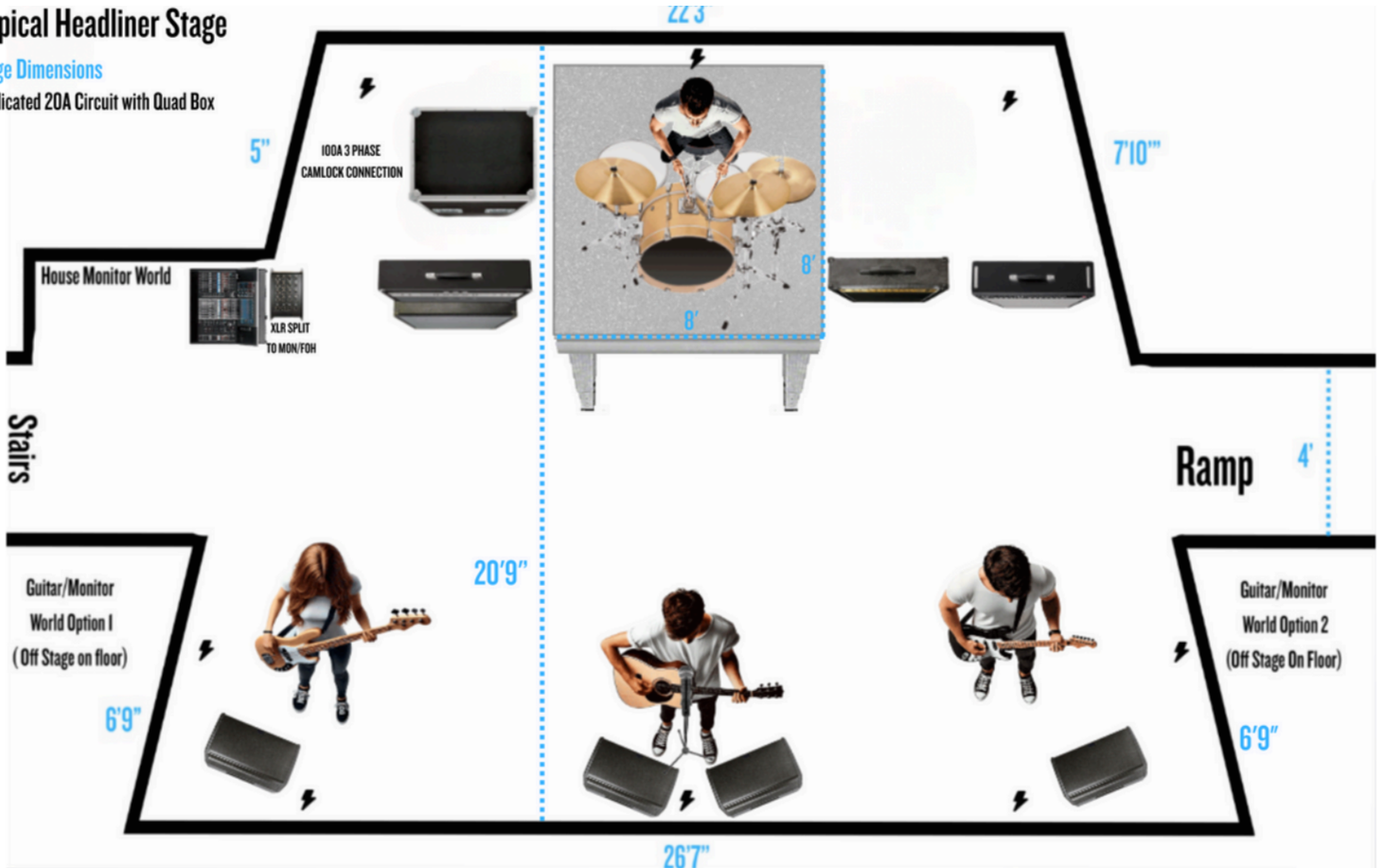

Typical Support Stage

Stage Dimensions

⚡: Dedicated 20A Circuit with Quad Box

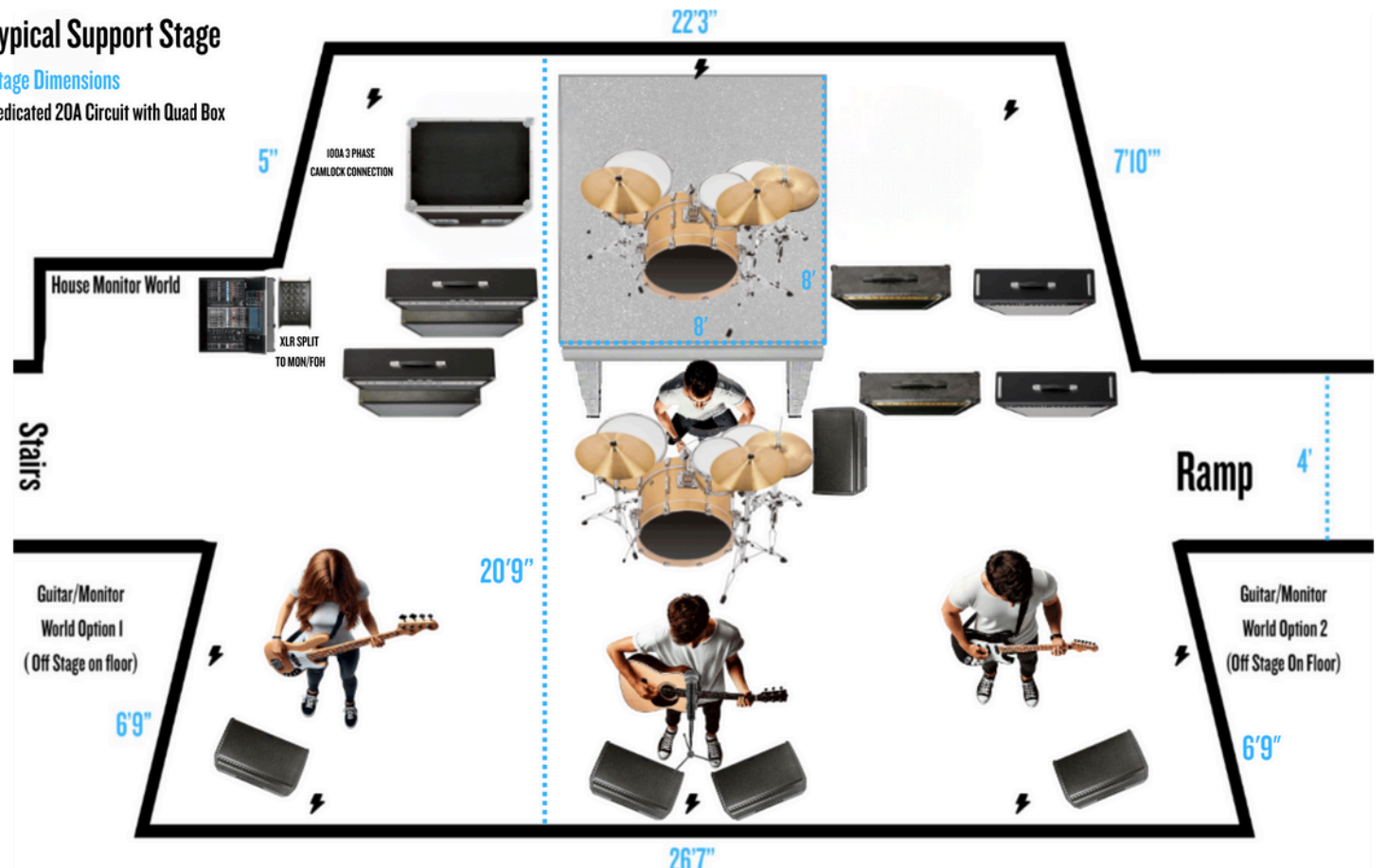

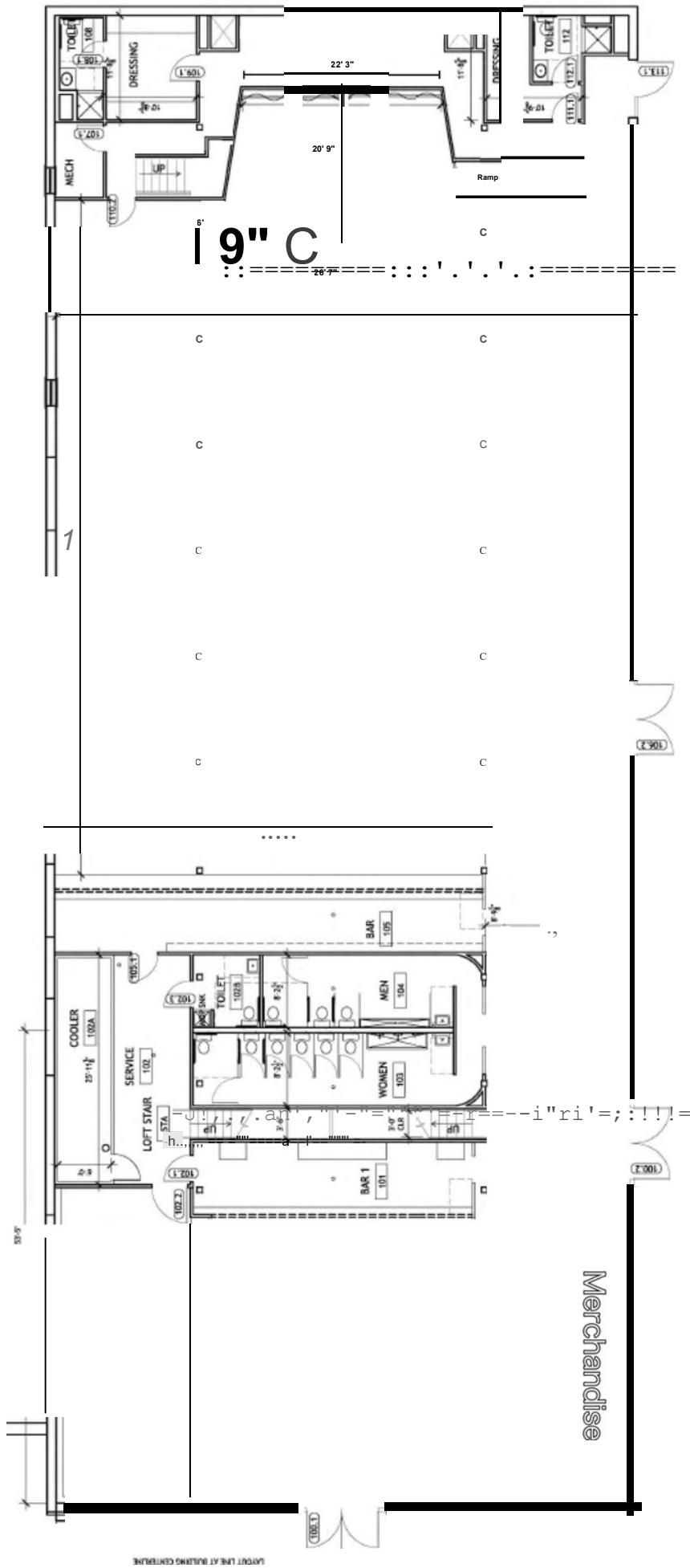

LOBBY LAYOUT AT BUILDING CENTRAL

Merchandise

Production Gear and Stage Info

PA System

db Technologies T12 Line Array - 3 Flown per side
db Technologies T8 - 1 Flown Per side
db Technologies K5 Fill - 1 Flown Center
Technologies S-30 subwoofer - 2 Ground Stacked Per Side- Under Stage

Front of House Audio System

**House FOH is on a rolling booth approximately 50' from stage, touring rigs are typically set up on the floor in front and barricaded off by security prior to doors.*

DigiCo SD9
2 - DigiCo D2 Stage Rack (shared with MON for a total of 98x32 I/O)
1 - Dolby Lake DLP 8d8 8ch Analog / AES

Monitor System

**House Monitor World is located upstage right, slightly off stage*

DigiCo SD9
2 - DigiCo D2 Stage Rack (Shared with FOH for a total of 98x32 I/O)
7 – EV PMX 12MP active monitors
5 - JBL SRX815p active monitors
1 - QSC KW181 active subwoofer

** We do not have any in-house IEM units available.*

Microphones

7 Shure SM58
6 Shure SM57
1 Sennheiser e935
2 Shure ULdX 2 wireless mics/receivers
2 Shure Beta 98a
5 Shure SM81
2 Shure Beta 52a
1 Shure KSM 137
2 Warm Audio WA-14
2 Sennheiser e906
1 Sennheiser e609
8 Sennheiser e604
1 Audix D6
1 CAD GXL1200BP
1 Audix D4
1 Audix F10

Miscellaneous

Whirlwind XLR Cables-VariouS Lengths
K&M Short and Tall Tripod Boom Microphone Stands
2 - Round Base Straight Microphone Stands
6 - Whirlwind Imp 2 Direct Boxes
1 - 8'x8'20" Drum Riser
Whirlwind XLR Snakes - Various Sizes

Stage Power

1- 100 - Amp Three-Phase Camloc Connection - located up stage right
8 - 20-amp AC Edison quads built into stage deck, all dedicated circuits

Stage Dimensions

Uneven hexagonal shaped stage
22'3" wide at back wall
20'9" deep
26'7" wide at front
6'9" from front lip to angled in section
11'8" angled in section to back corner
12'7" stage to ceiling in back corners 14'4" stage to ceiling in middle (peaked roof)
8'3" from stage to lowest flown upstage lighting fixtures
10'10" from floor to PA hang
4'6" from floor to stage
Ramp to stage Available

** See Stage Diagrams, Building Dimensions and further pictures starting on page 6*

Lighting System

Hoglet 4
4 Chauvet Intimidator Spot 355z IRC
4 Chauvet Intimidator Spot 475Z
2 Chauvet Rogue R1Z
8 Techni-Lux DM-VECTORLED712QB
8 Chauvet Slimpar Pro VW
4 Chauvet Strike 4 Blinder (2 Flown, 2 Available with Pole Stands if needed)
1 Ultratec Radiance Hazer
** Full Lighting Plot and Patch Sheet on Page 12*

***NOTE* MMH does not provide any in-house backline beyond what is listed. This includes drums, any instruments, extra wireless mics, amps, DJ gear, IEM units, etc. Rental information can be discussed per advance.**

FAQ

Where do we park and load in?

A map of our parking lot and loading zone can be found on page 14 of this packet. When you arrive, scan the QR code displayed in the parking lot and fill out vehicle information. Use promo code JHG and click apply. This will take the balance to 0. **This must be done within 15 minutes of arrival to avoid ticketing.**

Do you have a ramp to the stage ?

Yes. Ramp is located stage left. Stairs to stage are at stage right.

Do you have a drum riser available?

Yes, we have 1 8'x8'x20" riser. Typically this is used by the headliner, support acts will set up on the stage. We do not have any smaller ego risers available.

Can we hang a banner?

Yes, we have a raisable banner bar or a pulley system. Bar is 20' wide and can be raised to around 12'

Where can I set up guitar world/monitor world?

Guitar and monitor worlds are typically set up off stage near the downstage left/right corners. This area will be barricaded off during the show.

Do you have a stage barricade available?

Yes, we have a mojo style barricade that runs the length of the stage and uses bike racks to reach the wall.

I am bringing an audio console, how do I connect to your system?

LRSF drive lines can be taken at FOH by passing through the house console (Digico SD-9) on a flat matrix, OR can be taken at stage which will go direct to the PA processor.

I am bringing a lighting console, how do I connect to your system ?

DMX lines can be swapped at FOH with the house console (Hoglet-4). House LD will need these lines for any acts utilizing House LD, and can be passed during changeover.

Do you have CAT lines available ?

Yes, there are 4 guest CAT5 lines available. These run from FOH and can land at either side of the stage. **They are NOT shielded.**

Can I run my own snake/cabbling ?

Yes, you can run your own cabling from FOH to the stage through cable ramps and hooks that will run over the audience. The path from FOH up to the hooks, across the room, and back down to stage is roughly 90 feet.

Do you provide adequate stage power ?

There are 8 20 AMP AC Quad boxes positioned around the stage, all on dedicated circuits as well as 1 100 AMP 3 Phase Camlock connection positioned upstage right available for distro systems.

Do you provide in-house backline ?

No. Equipment beyond what is listed on page 9 of this packet can be rented from one of our local backline dealers. This must be discussed and approved 14 days prior to your event.

Do you provide in-house visuals?

We do not have any in-house visuals. Rental can be discussed per advance. This must be discussed and approved 14 days prior to your event.

I am using the house console, can I get an audio recording of my show?

House audio consoles do not have the required usb interface for multitrack in/out. We can provide a stereo XLR out with the house mix for a recorder, which you must provide. This must be arranged during your sound check.

Lighting Patch Sheet

Chauvet Intimidator Spot 355z IRC - 15ch			
101	2:25	US	Spot
102	2:66	US	Spot
103	2:109	US	Spot
104	2:153	US	Spot
Techni-Lux DM-VECTORLED712QB - 12ch			
201	2:40	US	Wash/Beam
202	2:53	US	Wash/Beam
203	2:81	US	Wash/Beam
204	2:170	US	Wash/Beam
205	2:183	US	Wash/Beam
206	2:95	US	Wash/Beam
207	2:125	US	Wash/Beam
208	2:139	US	Wash/Beam
Chauvet Intimidator Spot 475z - 16ch			
301	2:278	US	Spot
302	2:294	US	Spot
Chauvet Rogue R1X Spot - 19ch			
401	2:339	US	Spot
402	2:358	US	Spot
Chauvet SlimPar Pro VX - 3ch			
601	1:1	DS	Wash
602	1:7	DS	Wash
603	1:10	DS	Wash
604	1:13	DS	Wash
605	1:16	DS	Wash
606	1:22	DS	Wash
701	1:4	DS	Blinder
702	1:19	DS	Blinder
Chauvet Hurricane Haze 4D			
801	2:225		Hazer

Manchester Music Hall Lighting Plot 2026

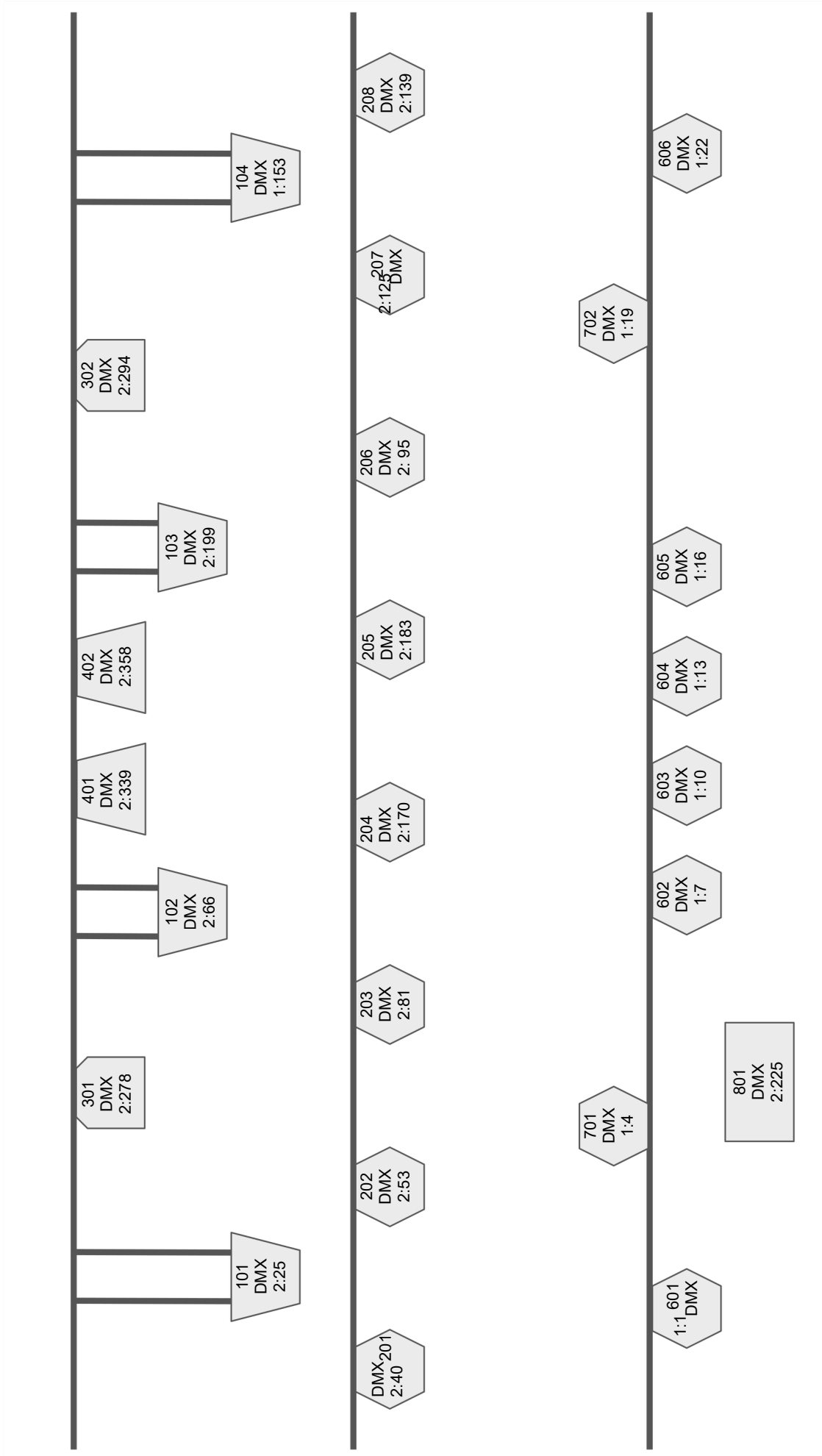

Property Map



Parking Validation



Must be completed within 15 minutes of arrival

- 1. Scan QR code**
- 2. Enter Plate Number**
- 3. Select “24 Hour”**
- 4. Click “Have a promo code?”**
- 5. Enter code “JHG”, apply**
- 6. Click “Pay with Card”**
- 7. Enter personal name AND artist name.**
Ex. “John Lennon(The Beatles)”
- 8. Enter Email**
- 9. Click Complete**